

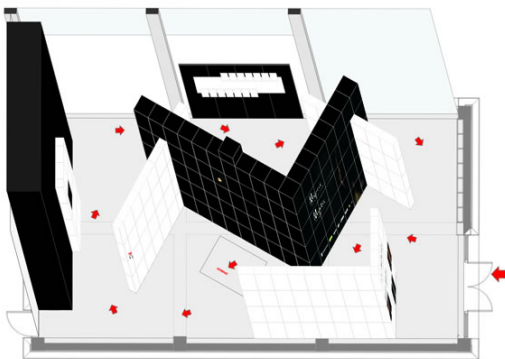

Having as a basis the initial concept of the exhibition, the entities and the rectangular multi-use hall of the Museum of Marble Crafts, the emphasis in the setup was to provide the optimum flow for the visitors, in order to have good viewing of the exhibits, good access to the explanatory panels and the interactive media that provide all the information for Myrtis.

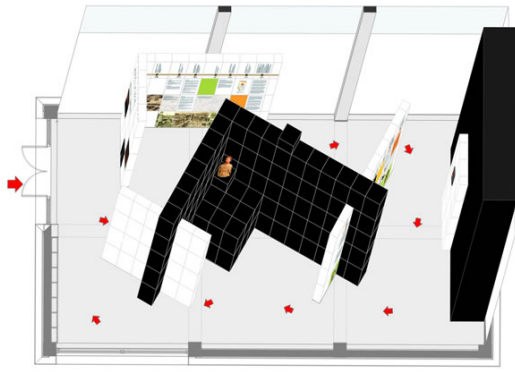







*Design adaptation and drafting by **George Kyriazis** (Interior Designer)*